

SECTIUNE TRANSVERSALA /
CROSS SECTION CS1,
WITH CAMBER = 0 mm

Sc. 1:75

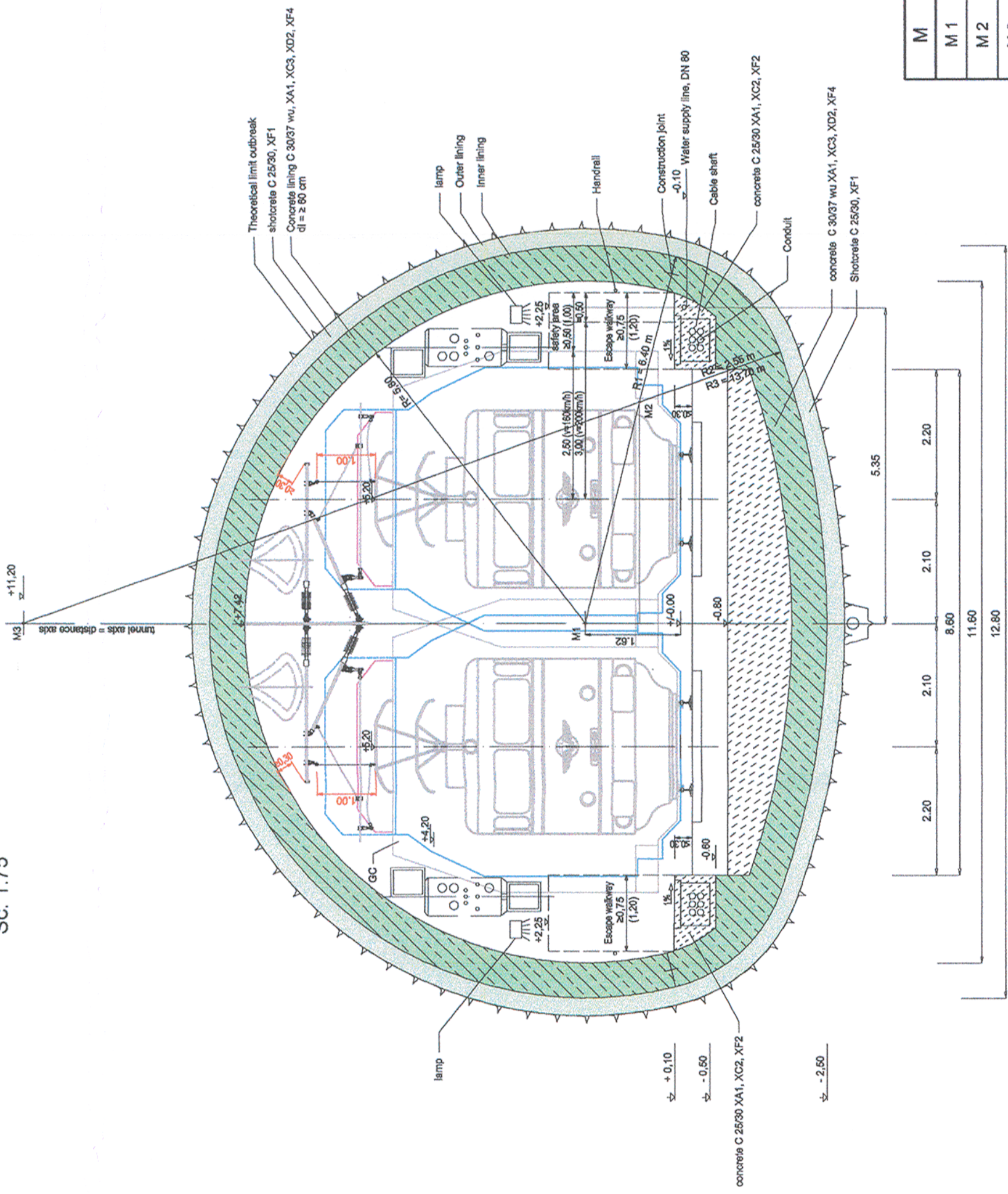

SECTIUNE TRANSVERSALA /
CROSS SECTION CS1,
WITH CAMBER = 150 mm

Sc. 1:75

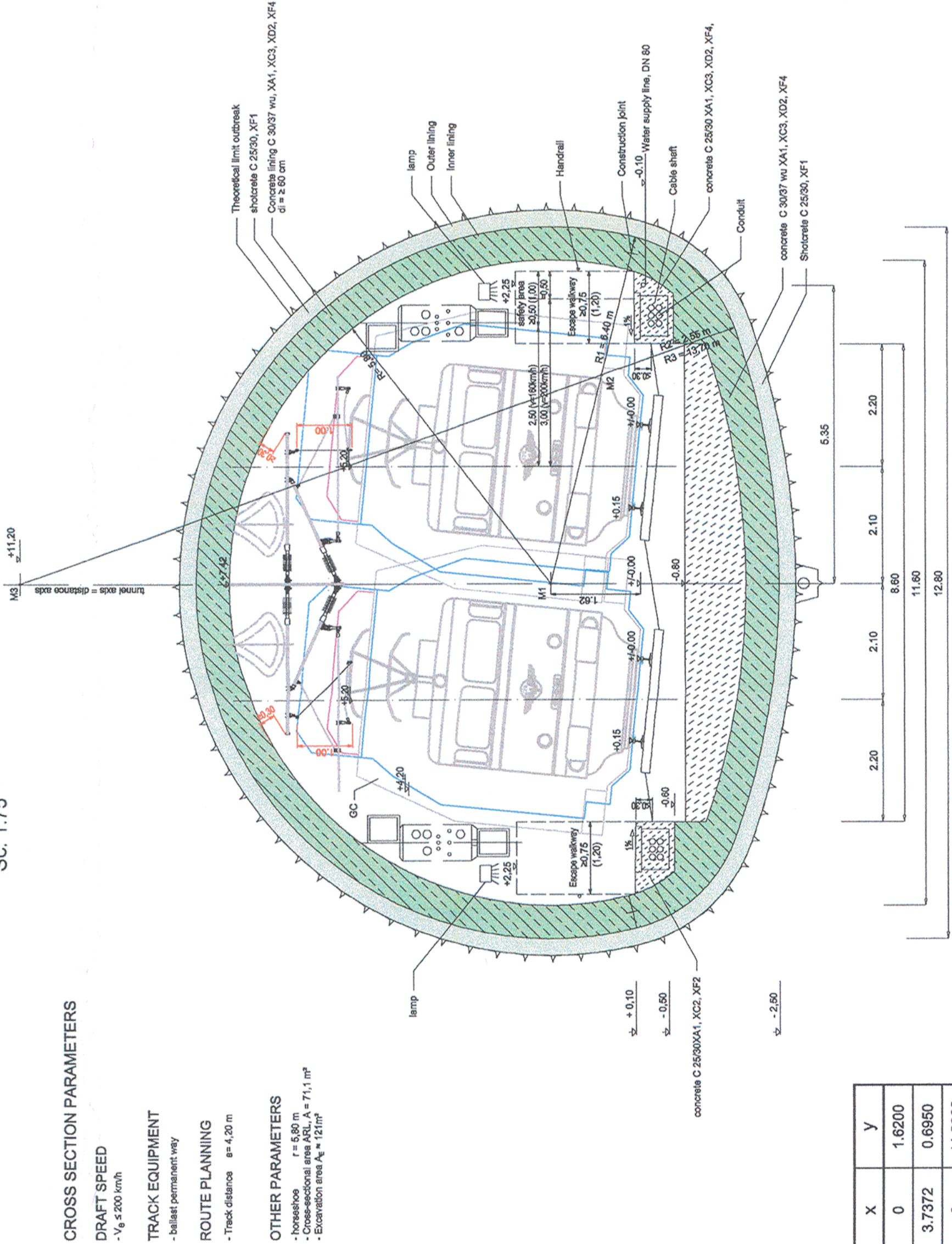

CROSS SECTION PARAMETERS

DRAFT SPEED

- $V_g \leq 200$ km/h

TRACK EQUIPMENT

- ballast permanent way

ROUTE PLANNING

- Track distance $s = 4,20$ m

OTHER PARAMETERS

- horseshoes
- $r = 5,80$ m
- Cross-sectional area $A_{CL} = 71,1$ m²
- Excavation area $A_g = 121$ m²



Verificator / Expert Checker / Expert	Cerinta Requirement	Semnatura Signature	Referat / Expertiza Report / Expertise
European Investment Bank	MINISTERUL TRANSPORTURILOR		
	BENEFICIAR / BENEFICIARY:		
	COMPANIA NATIONALA DE CAI FERATE "CFR" SA		
PROIECTANT / DESIGNER: PÖYRY			
Approbat Approved	Sef de echipa Team leader	C. Teodorescu	Data Date
Verificat Checked	Expert Cheile Key Expert	M. Diegmann	03/2013
Approbat Approved	Adjunct Sef de echipa Deputy Team leader	J. Werfling	03/2013
Proiectat Designed	Inginer Engineer	D. Ciotamel	03/2013
Semnatura Signature			
"Reabilitarea liniei c.f. Frontiera - Curtici - Simeria, parte componenta a coridorului IV Pan - European pentru circulatia trenurilor cu viteza maxima de 160 km/h"			
"Rehabilitation of the Railway Line Border - Curtici - Simeria, component Part of the IV Pan - European Corridor for the Trains Circulation with maximum speed of 160 km/h"			
Section 2 : km 614-Gurasada			
Denumire desen / Drawing name:			
CROSS SECTION, SC1, d = 60 cm, R = 5.80 m			
Project 91 35371.1			
PT			
Scara / Scale 1:75		Cod desen / Drawing Code CS 1	
Nr / No CS 1			